

Teddy Tag Quick Installation Guide For iOS

1 Download App and enable Bluetooth

- On your iOS smartphone running iOS 6 and above, iPad version 3/4 operating iOS 6 and above. iPad mini all versions, operating iOS 6 and above. iPad air and iPod Touch (version 4 operating iOS 6 and above). Download the free **Teddy Tag** App as illustrated in Figure 1 from the iTunes App store. **Apps for iPhone or Safari.**
- Enable Bluetooth on your iOS device as illustrated in Figure 2.

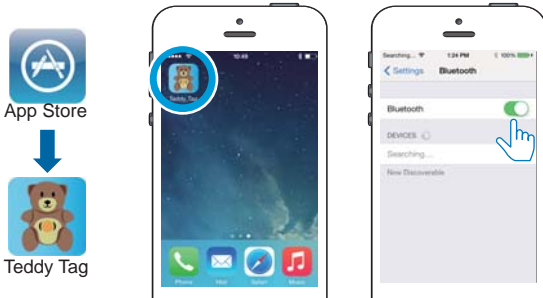

Figure 1

Figure 2

Airplane Mode

Teddy Tag is a device used by most people when travelling and can quickly and efficiently be temporarily disabled by simple enabling airplane Mode" on your mobile device. At this time, **ALL** connected tags will emit and audible alarm, then enter a "sleep condition" and will stop transmitting. Each tag will only reawaken, when "airplane mode" on your mobile device is disabled.

Please note: On disabling airplane mode, it may take up to 1 minute for each tag to reconnect.

3 Locate your iPhone/iPad or Teddy Tag

To simply test the paired device and to Locate your iPhone/iPad

Press and immediately release the "Find Me" button as illustrated in Figure 5. Your iOS device will emit an audible signal for approximately 5 seconds.

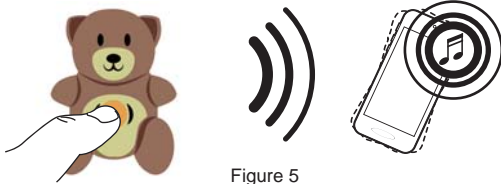
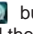

Figure 5

To locate your valuables attached to the Teddy Tag

Tap the  button (as illustrated in Figure 6), the Teddy Tag will emit a beeping sound and then continue to beep for approximately 5 seconds.

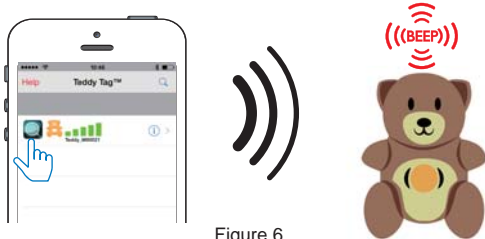
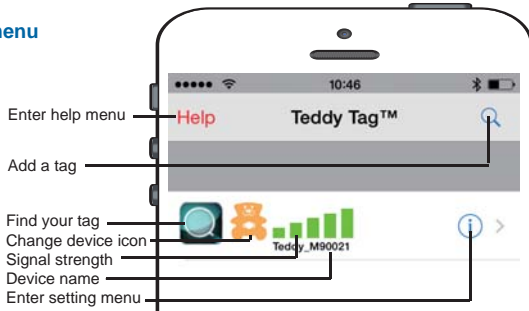

Figure 6

5 Main Menus and Device Setting Menu

Main menu



Device setting menu

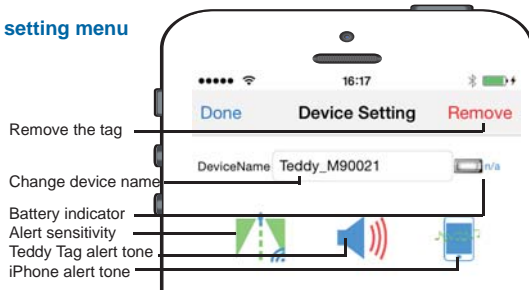

2 Charging the Teddy Tag battery and pairing

Charging your Teddy Tag

Take the cable supplied in the package and use the smaller Micro USB connector to attach it to the "Micro USB Port" on the Teddy Tag; then take the larger standard USB connector on the cable and attach it to a computer USB port or a USB wall-plug power adapter. The red LED indicator will blink when charging. Once the Teddy Tag is fully charged, red LED will light up all and stop charging.

Important: The Teddy Tag comes charged and ready to go, but after the initial use, normal charging will take only 2 to 3 hours for maximum power.

Pairing

- Press the FindMe (Orange) button once to enter the pairing mode (indicated by the device's blue indicator flashing once per second).
- Run the **Teddy Tag** Application on your iOS device by tapping the **Teddy Tag** icon, then tap the search button  (See figure 3) to discover all available devices.
- The App will then present you with a Bluetooth pairing request (See figure 4) and Select "Pair" for each device (Up to a maximum of four). The device will then enter paired (connected) mode and the blue LED will blink once every 5 seconds.

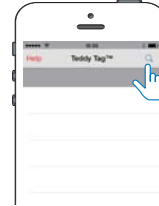





Figure 3



Figure 4

4 Notification alert when your iPhone/iPad and Teddy Tag are out of range

Alarm Sensitivity Settings (The default setting is in far or low sensitivity) To select the distance at which your iOS device and Teddy Tag are out of range tap the  icon to the right of each paired device list. On tapping it, the images to the left will appear.  Green Far / low sensitivity,  Red Near / High sensitivity,  Grey Off or no sensitivity.

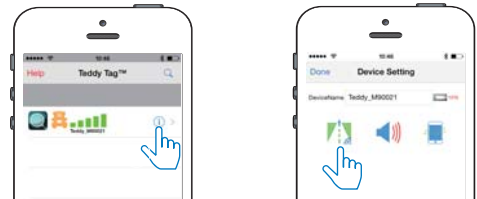

When the item tagged is beyond the set range, both the Teddy Tag and your iOS device will emit an audible tone.

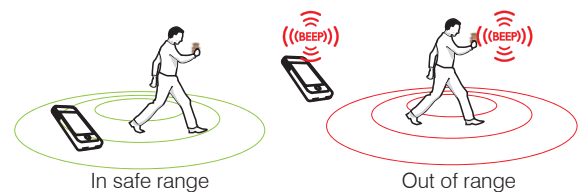

6 Power the Teddy Tag off or on

Powering the Teddy Buddy™ Bear off (Manual Shutdown)

To manually turn the paired Teddy Buddy™ Bear to the off-state, depress and hold the function (Orange) button on the Teddy Buddy™ Bear for 5 seconds or until a prompt appears asking you to confirm the manual shutdown request. Once the shutdown request has been confirmed, the Teddy Buddy™ Bear will sound an extended (long) beep. Let go of the function button on the Bear as soon as this long beeping alert is heard and the Teddy Buddy™ Bear will shut down.

WARNING! In the "OFF" state, the Teddy Buddy™ Bear closes all connections and all functions will be disabled.

Powering the Teddy Buddy™ Bear on (Manual Startup)

To manually turn the paired Teddy Buddy™ Bear to its on state, press the function (Orange) button once and the paired Teddy Buddy™ Bear should attempt to reconnect with the paired iOS mobile device. Audible beeps should alert the user that Bluetooth connection has been re-established and the proximity indicator bars should show the relative range of the paired Teddy Buddy™ Bear on screen.

